

CHANNEL MAGNET



- Channel Magnet consists of high coercivity modern anisotropic Permanent Magnet like Ferrite &/or Rare Earth magnets
- Strong & Rugged construction with M.S or S.S 304/316 construction.

Permanent channel Magnet are used for the removal of iron from less strongly contaminated material from material like Rice, Flour, Glaze, Slip (ceramic material), Glass, Mineral powder, Slurry, Chemical, Liquid material, Food products for any kind material processing machine or machine outlet.

The permanent magnetic channel are designed in various sizes & strength to meet the specific operation and plant condition. The channel magnet can ideally be used to remove tramp iron from material carried in chute. It is very useful for chemical slurry.

Product specification varies with specific application needs. Discuss your requirement with us for the most suitable product.

HUMP MAGNET

Magnetic Humps are used where the flow of material is vertical. The material falling strikes directly on the first magnet changes direction and falls over the second magnet, ensuring clean outflow of material. The Magnets are of Hinged type and can be easily opened for periodic cleaning. Hump Magnets can be supplied to suit any size of Pipe/Duct.

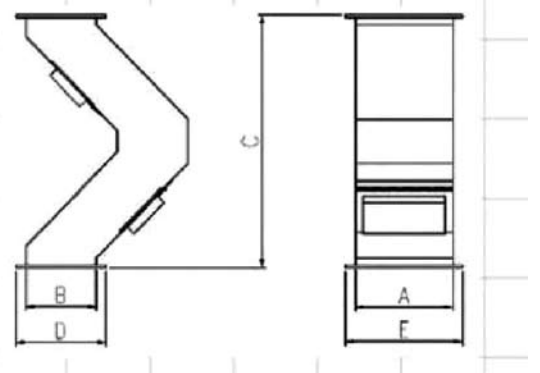

Product specification varies with specific application needs. Discuss your requirement with us for the most suitable product.

Part No	A	B	C	D	E
HM-120	120	150	470	170	200
HM-150	150	178	750	250	220
HM-200	200	178	750	300	220
HM-250	250	178	750	350	220
HM-300	300	178	750	400	220
HM-350	350	200	1110	450	300
HM-400	400	200	1110	500	300
HM-450	450	200	1110	550	300
HM-500	500	200	1110	600	300



Due to continuous upgradation in design there could be changes in specification. Other sizes on request. Before ordering, contact Lifton Magnets or your nearest dealer to confirm the suitability of this model for your application.

