

PM

HANDLIFT

HAND OPERATED SHEET LIFTER

FEATURES

- Easy grip powerful magnet with handle.
- Can lift/ drag top sheet from stack for pulling out without any damage.
- Optimum flux density – effectively lifts thick/ thin sheets.
- Magnets are always ON. To release a cam mechanism pushes down the sheet at contact point.



APPLICATIONS

- Useful for press shop for feeding one sheet at time in machine.
- These are used in single or in pairs for carrying sheets for either horizontal or vertical transportation.
- Most suitable for pulling or carrying steel sheets or material sheets of 3 X 1000 X 2000 mm.

Caution : Do not use it as a hoist for handling finished components after grinding operation, use thin plastic sheet to avoid scratch.

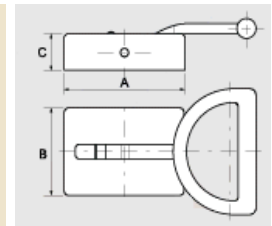

Product Code : HL

All dimensions are in mm.

PART NO	W	L	H	LIFT CAP (Kgs)	SLIDING FORCE (Kgs)	WEIGHT (Kgs)
9	100	150	35	90	35	3.0

Due to continuous upgradation in design there could be changes in specification. Other sizes on request. Before ordering, contact Lifton Magnets or your nearest dealer to confirm the suitability of this model for your application.

PM

SHEETLIFT

CRANE OPERATED SHEET LIFTER

FEATURES

- Simple, easy, flexible, economical and very light weight.
- Can swivel 150° and lift sheets vertically and horizontally.
- Can lift non homogeneous parts with unbalanced weight and load.
- Optimum flux density effectively lifts thick/ thin sheets.
- Magnets always remain ON.
- Cam mechanism jack up lever releases the jobs easily with the help of long handle.

APPLICATIONS

- Useful in shop floor for stacking of sheets size 1000 x 2000 mm.
- Suitable for loading/unloading of plates from horizontal milling machine.
- Most suitable near flame cutting machines.



Product Code : SL

All dimensions are in mm.

PART NO	W	L	LIFT CAP (Kgs)	SLIDING FORCE (Kgs)	WEIGHT (Kgs)
25	110	210	250	75	6.5
50	180	320	500	150	13.5

Due to continuous upgradation in design there could be changes in specification. Other sizes on request. Before ordering, contact Lifton Magnets or your nearest dealer to confirm the suitability of this model for your application.

Caution :For handling finished components after grinding operation, use thin plastic sheet to avoid scratch.



PM

TOUCHLIFT

HAND OPERATED GRIPPER

FEATURES

- Handy with easy gripper.
- Attracts and removes with one touch jack up lever.
- Low field magnetic power to handle finished components.
- Can handle oily/ warm components.



APPLICATIONS

- To hold small/complex shaped components while polishing/grinding.
- To lift oily finished grinded jobs from surface grinding machine.
- Useful during critical welding application.

Product Code : TL

All dimensions are in mm.

PART NO	W	L	H	LIFTING CAPACITY (Kgs)	WEIGHT (Kgs)
10	100	60	40	25	1.2

Due to continuous upgradation in design there could be changes in specification. Other sizes on request. Before ordering, contact Lifton Magnets or your nearest dealer to confirm the suitability of this model for your application.

